

# ORECK<sup>®</sup> XL<sub>|||||</sub><sup>®</sup>

S I M P L Y   A M A Z I N G<sup>®</sup>

## Service Parts List



### Upright Vacuum Cleaner Models

XL9200

XL9800

XL9000W

XL9000D

XL9100C

XL9100HG

XL9300 / 9300S

XL9300MS

XL9300C

XL9300G

XL9300H

XL9300MM

REV AP, Please disregard all earlier versions.

# Service Information

- Component configuration on exploded view may differ in case of specific versions. However, the actual components are distinguished by means of item and part numbers.
- If a repair has been made, make sure that all functions of the appliance are working correctly.
- Spare parts have been standardized as much as possible and the part may not be the exact replacement part.
- Only the new **METAXALLOY™** motor fan available.
- Only the new soft single rear wheel style available.
- Only housings with belt access door available.
- When assembling fan seal to fan housing, use a small bead of silicone.
- If handle is falling, tighten center screw in baseplate before servicing.
- When ordering a new housing to replace housing without a belt door, order the belt door #40 and screw #48.
- Baseplate assemblies with one-piece wireform are interchangeable on all units.

## REPLACEMENT DUST BAGS

Item	Order #	Qty.	Pk.
Dust Bags (9 Pk.), Regular, Non-Docking System	PK80009	1	9
Dust Bags (25 Pk.), Regular, Non-Docking System	PK800025	1	25
Dust Bags (9 Pk.), Hypo Allergenic, Non-Docking System	PK80009DW	1	9
Dust Bags (25 Pk.), Hypo Allergenic, Non-Docking System	PK800025DW	1	25

## TOOLS

Description	Order #			
Fan Housing Removal Tool (This tool is designed to assist in removing fan housing assembly from the motor.)	75377-01			
Strain Relief Pliers (This tool is designed to remove the cord retainer, part #33.)	75383-01			
Retainer Clip Tool (This tool is designed to assist in adding retainer clip, part #67, to Baseplate with posts.) <b>***Use 7/32" nut driver.</b>	75485-01	NLA	NLA	NLA

## RETAINER CLIP REPLACEMENT

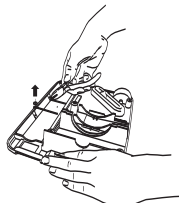

To remove the retainer clips from the baseplate, using a pair of side cutting pliers, carefully cut the retainer clips away from the posts. Remove the retainer clips. Be careful not to damage the posts.

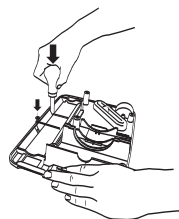

To replace the retainer clips, position the retainer clips on the posts with indentation facing downward. Use the retainer clip tool (7/32" nut driver) to force the retainer clips down. Retainer clip should fit firmly against wireform.

# STANDARD FASTENER HARDWARE LISTING

## Fasteners Fit All Uprights Listed in Service Manual

#	PART DESCRIPTION	FASTENER PART NO.	FASTENER DESCRIPTION	QTY REQ'D	TORQUE RANGE (in/lb)	QTY PER PKG.			
2	Cable Clamp	03-00449-01M		1		100			
3	Handle Tube Screw	03-00450-01M	#10 X .5 Phillips	2	13 - 16	100			
15	Foot Switch Nozzle Screw	03752-01M	#8 X .5 Phillips	2	13 - 16	100			
15	Headlight Cover Screw	03752-01M	#8 X .5 Phillips	2	13 - 16	100			
15	Bulb Holder Screw	03752-01M	#8 X .5 Phillips	2	13 - 16	100			
30	Fan Nut	03-00448-01M	1/4 X 32 Yellow Chrome	1	18 - 20	100			
37	Motor Screw, Intake Pivot	03-00476-01M	#8 X .75 Phillips	2 / 1	13 - 16	100			
37a	Motor Screw w/Integral Head (Fits Old-Style Motor)	03-00471-01M	#8 X .5 Slotted Phillips	1	13 - 16	100			
38	D Handle Screw	03-00456-01M	#8 X .75 Phillips (with small head)	4	13 - 16	100			
41	Wire Nuts	03-00599-01M	Wire Nut	as req'd	35 - 55	100			
48	Baseplate Screw	03-00476-01M	#8 X .75 Phillips	5	13 - 16	100			
48	Belt Door Screw	03-00476-01M	#8 X .75 Phillips	1	13 - 16	100			
49	Edge Brush Screw	03-00475-01M	#7 X .38 Phillips	2	5 - 8	100			
63	Cord Bracket Screw	03-00450-01M		2	13 - 16	100			
67	Retainer Clip (used only on baseplate with posts)	03528M		2	n/a	100			
68	Wireform, Baseplate (used only on baseplate w/ posts)	75194-03M		2	n/a	100			
69	Rivet	03-00453-01M		1	n/a	100			
70	Bag Spring	75015-01M		1	n/a	100			
71	Push Nut	03-00636-01M		1	n/a	100			

## STANDARD REPLACEMENT PARTS

KIT NUMBER	DESCRIPTION			
	<i>Note: Standard motor replacement kits will replace old style motors.</i>			
09-75535-01	Kit, Motor			
75086-01	Lead, Red		NLA	NLA
75086-02	Lead, White		NLA	NLA
75506-01	Lead, Green		NLA	NLA
▲ 09-75388-01	Connector Assembly w/Deflector, Stiffener & Collar		NLA	NLA

▲ If you have a bent handle (1a), order 75219-02 (1 each, straight handle assembly) & 03-00478-02 (2 each, screws)  
 If you have a straight handle (1b or 1c), order 75190-03 (1 each, handle tube) & 03-00478-02 (2 each, screws)

## OLD STYLE REPLACEMENT PARTS

Item	Order #	Qty.	Pk.			
Assy. Motor Brush (2) / Spring (2)	0101186	2	1			
Motor Cover	0132954	1	1	NLA	NLA	NLA
Old Fan Housing	6034965	1	1			
Old Intake Tube (Lower Tube)	0169546	1	1	NLA	NLA	NLA

# Parts Diagram

**RIGHT**

**LEFT**

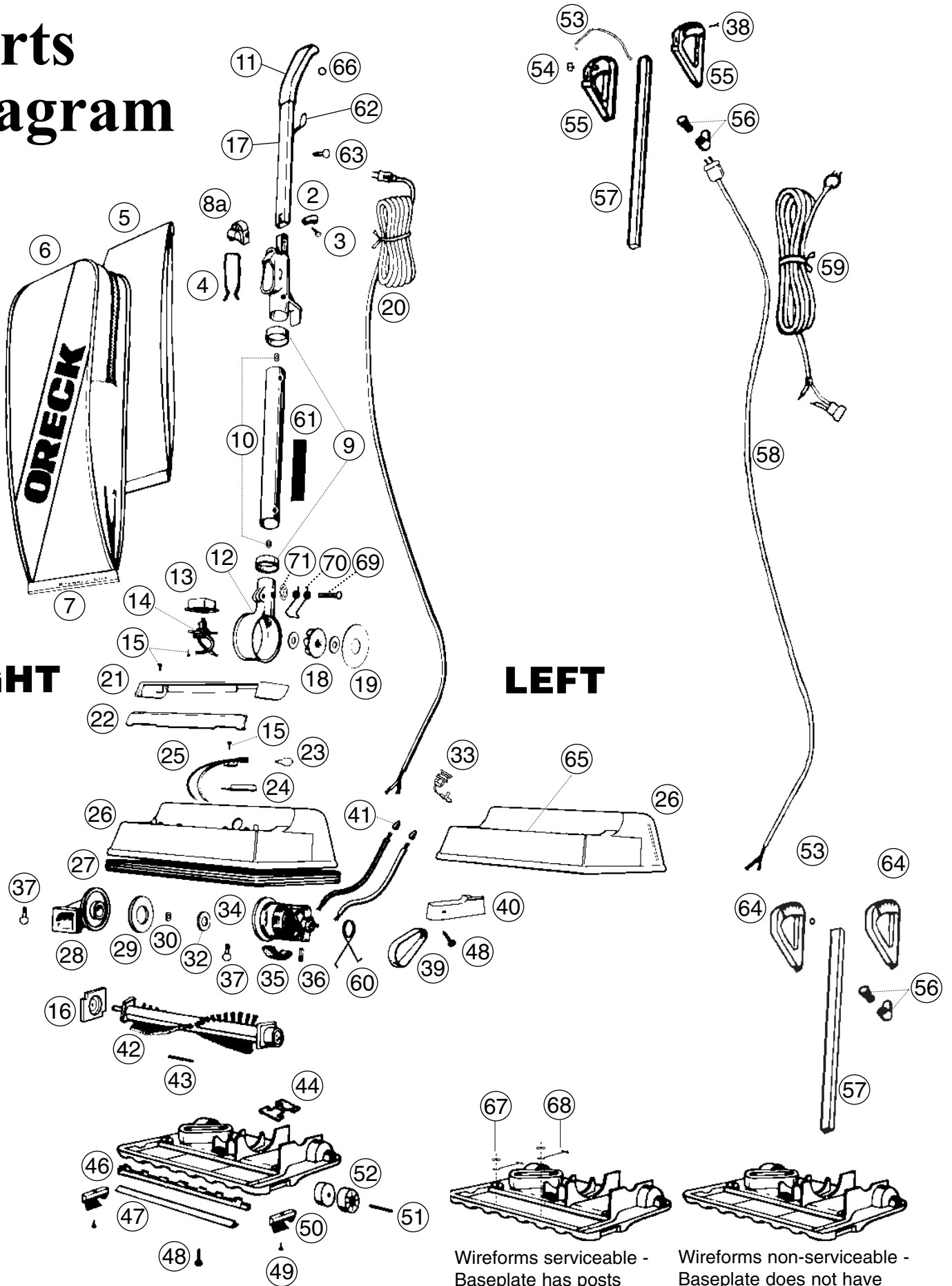

Wireforms serviceable -  
Baseplate has posts

Wireforms non-serviceable -  
Baseplate does not have posts

# Parts Assemblies

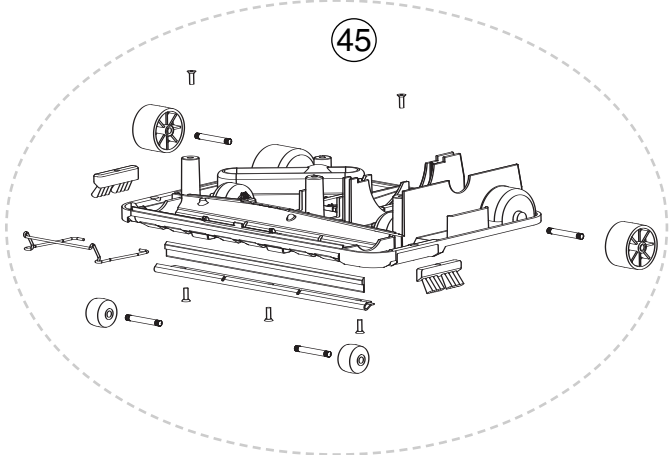
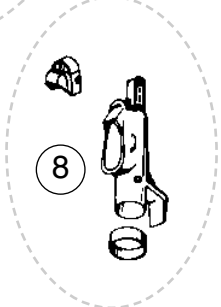
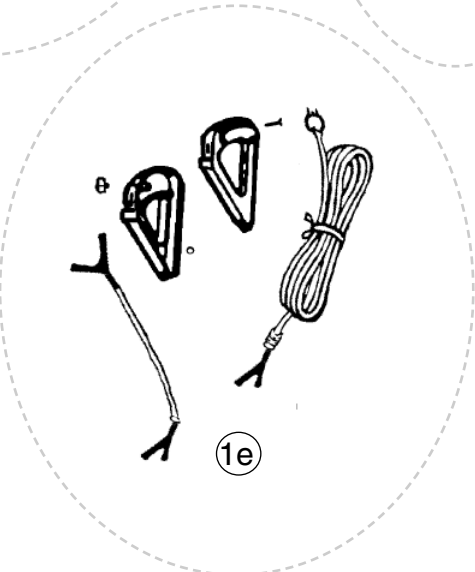
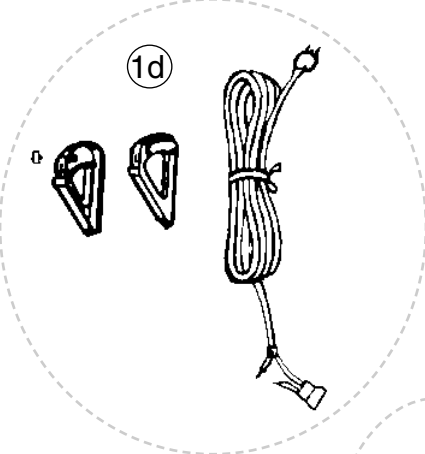
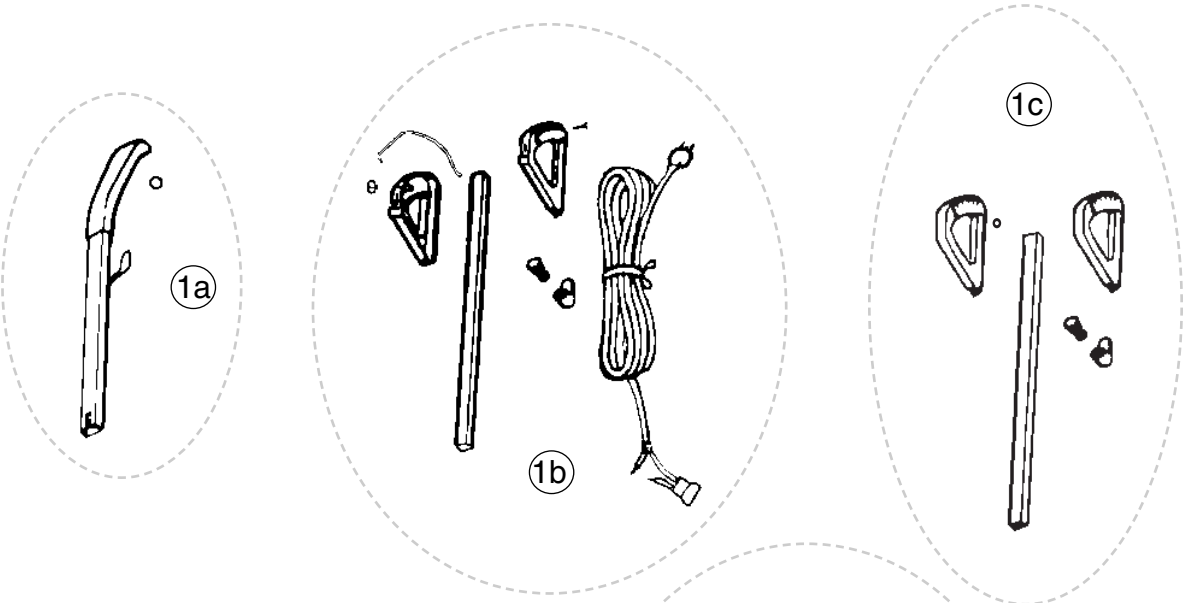

# Part Numbers Listing: XL9200

Hypo Bag, Lights, Helping Hand Handle, 2-Speed

#	Item	Order #	Qty.	Pk.			
1b	Handle Assembly, <i>Includes: #38, #53, #54, #55, #56, #57, #59</i>	09-75296-01	1	1			
1d	Grip & Cord Assembly, <i>Includes: #54, #55, #59</i>	09-75342-12	1	1	NLA	NLA	NLA
1e	Kit, Retro, Handle Assembly, Residential, White	09-75612-01	1	1			
4	Bag Retainer Spring	75035-02	1	1			
6	Outer Bag, Lt. Gray, Black, Dark Gray	75246-10	1	1			
7	Bag Clip, Blue Gray	09-75078-02	1	1			
8	Connector Assembly w/Deflector & Collar	0152657	1	1			
8a	Deflector, Black	75220-01-0327	1	1			
9	Collar	0132513	2	1			
10	Tube Assembly w/Seal & Clips, Lower	75017-01	1	1			
12	Fan Housing Assembly, <i>includes Rivet &amp; Spring</i>	09-75233-01	1	1			
16	End Cap, Left	0134623	1	1			
18	METAXALLOY™ Fan Kit w/Washers	09-75300-01	1	1			
19	Fan Cup Seal	75012-01	1	1			
20	Cord Set	<b>see #59</b>					
21	Lamp Housing w/Reflectors, White	09-75073-05	1	1			
22	Lens	75058-01-0329	1	1			
23	Bulb	00965-0019	2	1			
24	Bulb Reflector	75034-01	4	1			
25	Lamp Holder	75539-01	1	1			
26	Housing w/Reflectors, White, <b>when replacing on unit w/o belt door order #40 &amp; #48 also</b>	09-75270-02	1	1			
27	Bumper, Blue Gray	75181-01	1	1			
28	Intake Pivot Assembly, <i>with Felt Seal</i>	09-75066-02	1	1			
29	Felt Seal	75065-01	1	1			
32	Felt Seal, Motor	75117-01M	1	100			
33	Cord Retainer Round	03-00455-01	1	1			
34	Motor Assembly Kit	09-75535-01	1	1			
35	Motor Seal	75095-01	2	1			
36	Kit, Motor Brush (Large & Small) / Spring	09-75514-01	2	2			
39	Drive Belt, (3 Pk.)	0300604	1	3			
39a	Drive Belt, Single	75024-01	1	1			
40	Door (Belt), White	75057-01-0431	1	1			
42	Brush Roll, Plastic Pulley	75202-01	1	1			
43	Seal, Baseplate	75008-01	1	1			
44	Spring Detent	75036-01	1	1			
45	Complete Baseplate Assembly, <b>order #44 also</b>	09-75715-01	1	1			

# Part Numbers Listing: XL9200 cont.

Hypo Bag, Lights, Helping Hand Handle, 2-Speed

#	Item	Order #	Qty.	Pk.			
46	MICRO SWEEP Blade	75009-01	1	1			
47	Channel	75007-02	1	1			
50	Edge Brush w/Wheels, Left	09-75249-02	1	1			
	Edge Brush w/Wheels, Right	09-75250-02	1	1			
51	Wheel Axle	03-00630-01M	2	100			
52	Soft Rear Wheel, Black	75187-02-0327	2	1			
53	Static Wire	75037-01	1	1			
54	Switch, 3 Position Assembly w/Diode	75320-01	1	1			
55	Grips, Blue Gray Set, <b>Order Assembly 1e</b>						
56	Cord Wrap Assembly <i>includes:</i> Post and Cord Wrap	09-75185-02	1	1			
57	Handle Tube	75029-01	1	1			
58	Cord, Harness Assembly	75081-01	1	1			
59	Cord Set, <b>Order Assembly 1e</b>						
60	Motor Spring	75283-01	2	1			
61	Tube Label	75087-06	1	1			
	User's Manual	75416-05	1	1			
	Magnet Clean Vacuum Protector	MC4BK	1	1			

# Part Numbers Listing: XL9800

## Regular Bag, Lights, Helping Hand Handle

#	Item	Order #	Qty.	Pk.			
1b	Handle Assembly <i>includes items #38, #53, #54, #55, #56, #57, #59</i>	09-75296-03	1	1			
1d	Grip & Cord Assembly <i>includes: #54, #55, #59</i>	09-75342-04	1	1	NLA	NLA	NLA
1e	Kit, Retro, Handle Assembly, Residential, White	09-75612-01	1	1			
4	Bag Retainer Spring	75035-02	1	1			
6	Outer Bag, Dark Gray, Black, Dark Gray	75246-11	1	1			
7	Bag Clip, Black	09-75078-03	1	1			
8	Connector Assembly w/Deflector & Collar	0152657	1	1			
8a	Deflector, Black	75220-01-0327	1	1			
9	Collar	0132513	2	1			
10	Tube Assembly w/Seal & Clips	75017-01	1	1			
12	Fan Housing Assembly <i>includes Rivet &amp; Spring</i>	09-75233-01	1	1			
16	End Cap, Left	0134623	1	1			
18	METAXALLOY™ Fan Kit w/Washers	09-75300-01	1	1			
19	Fan Seal Cup	75012-01	1	1			
20	Cord Set	<b>see #59</b>					
21	Lamp Housing w/Reflectors, Black	09-75073-04	1	1			
22	Lens	75058-01-0329	1	1			
23	Bulb	00965-0019	2	1			
24	Bulb Reflector	75034-01	4	1			
25	Lamp Holder	75539-01	1	1			
26	Housing, Black <b>when replacing on unit w/o belt door order #40 &amp; #48 also</b>	09-75429-01	1	1			
27	Bumper, Clear	75181-04	1	1			
28	Intake Pivot Assembly, <i>with Felt Seal</i>	09-75066-02	1	1			
29	Felt Seal	75065-01	1	1			
32	Felt Seal, Motor	75117-01M	1	100			
33	Cord Retainer, Round	03-00455-02	1	1			
	Cord Retainer, Square	03-00494-01	1	1			
34	Motor Assembly Kit	09-75535-01	1	1			
35	Motor Seal	75095-01	2	1			
36	Kit, Motor Brush (Large & Small) / Spring	09-75514-01	2	2			
39	Drive Belt, (3 Pk.)	0300604	1	3			
39a	Drive Belt, Single	75024-01	1	1			
40	Door (Belt), Black	75057-01-0327	1	1			
42	Brush Roll, Plastic Pulley	75202-01	1	1			
43	Seal, Baseplate	75008-01	1	1			
44	Spring Detent	75036-01	1	1			





# Part Numbers Listing: XL9000W

Regular Bag, No Lights, Foot Switch

#	Item	Order #	Qty.	Pk.			
1a	Handle Assembly	75030-03	1	1			
4	Bag Retainer Spring	75035-02	2	1			
6	Outer Bag, Dark Gray, Black, Dark Gray	75246-11	1	1			
7	Bag Clip, Black	09-75078-03	1	1			
8	Connector Assembly w/Deflector & Collar	0152657	1	1			
8a	Deflector, Black	75220-01-0327	1	1			
9	Collar	0132513	1	1			
10	Tube Assembly w/Seal & Clips	75017-01	1	1			
11	Grip, Handle, White	75272-01	1	1			
12	Fan Housing Assembly <i>includes: Rivet &amp; Spring</i>	09-75233-01	1	1			
13	Switch Cover	09-75266-01	1	1			
14	Switch Assembly	75084-06	1	1			
16	End Cap, Left	0134623	1	1			
18	METAXALLOY™ Fan Kit w/Washers	09-75300-01	1	1			
19	Fan Seal Cup	75012-01	1	1			
20	Cord Set	75163-03-328	1	1			
26	Housing (White) <b>when replacing on unit w/o belt door order #40 &amp; #48 also</b>	09-75430-01	1	1			
27	Bumper (Clear)	75181-04	1	1			
28	Intake Pivot Assembly with Felt Seal	09-75066-02	1	1			
29	Felt Seal	75065-01	1	1			
32	Felt Seal, Motor	75117-01M	1	100			
33	Cord Retainer, Round	03-00455-01	1	1			
	Cord Retainer, Square	03-00494-01	1	1			
34	Motor Assembly Kit	09-75535-01	1	1			
35	Motor Seal	75095-01	2	1			
36	Kit, Motor Brush (Large & Small) / Spring	09-75514-01	2	2			
39	Drive Belt, (3 Pk.)	0300604	1	3			
39a	Drive Belt, Single	75024-01	1	1			
40	Door Belt, White	75057-01-0431	1	1			
42	Brush Roll, Plastic Pulley	75202-01	1	1			
43	Seal, Baseplate	75008-01	1	1			
44	Spring Detent	75036-01	1	1			
45	Complete Baseplate Assembly, <b>order #44 also</b>	09-75715-01	1	1			
46	MICRO SWEEP Blade	75009-01	1	1			
47	Channel	75007-02	1	1			
50	Edge Brush w/Wheel, Left	09-75249-02	1	1			
	Edge Brush w/Wheel, Right	09-75250-02	1	1			

# Part Numbers Listing: XL9000W cont.

Regular Bag, No Lights, Foot Switch

#	Item	Order #	Qty.	Pk.			
51	Wheel Axle	03-00630-01M	2	100			
52	Soft Rear Wheel, Black	75187-02-0327	2	1			
60	Motor Spring	75283-01	2	1			
61	Tube Label	75087-06	1	1			
62	Cord Bracket	75245-01	1	1			
65	"Oreck" Name Plate Label	75599-03	1	1			
66	Bushing	75275-01	1	1			
	User's Manual	75416-05	1	1			
	Vacuum Cleaner Cover	VACCOVER	1	1	NLA	NLA	NLA
	Magnet Clean Vacuum Protector	MC4BK	1	1			

# Part Numbers Listing: XL9000D

Regular Bag, No Lights, D Handle, Foot Switch

#	Item	Order #	Qty.	Pk.			
1c	Handle Assembly	09-75093-01	1	1			
4	Bag Retainer Spring	75035-02	1	1			
6	Outer Bag, Dark Gray, Black, Dark Gray	75246-11	1	1			
7	Bag Clip, Black	09-75078-03	1	1			
8	Connector Assembly w/Deflector & Collar	0152657	1	1			
8a	Deflector, Black	75220-01-0327	1	1			
9	Collar	0132513	1	2			
10	Tube Assembly w/Seal & Clips	75017-01	1	1			
12	Fan Housing Assembly <i>includes: Rivet &amp; Spring</i>	09-75233-01	1	1			
13	Switch Cover	09-75266-01	1	1			
14	Switch Assembly	75084-06	1	1			
16	End Cap, Left	0134623	1	1			
18	METAXALLOY™ Fan Kit w/Washers	09-75300-01	1	1			
19	Fan Seal Cup	75012-01	1	1			
20	Cord Set	75163-03-328	1	1			
26	Housing, White <b>when replacing on unit w/o belt door order #40 &amp; #48 also</b>	09-75430-01	1	1			
27	Bumper, Clear	75181-04	1	1			
28	Intake Pivot Assembly <i>with Felt Seal</i>	09-75066-02	1	1			
29	Felt Seal	75065-01	1	1			
32	Felt Seal, Motor	75117-01M	1	100			
33	Cord Retainer, Round	03-00455-01	1	1			
	Cord Retainer, Square	03-00494-01	1	1			
34	Motor Assembly Kit	09-75535-01	1	1			
35	Motor Seal	75095-01	2	1			
36	Kit, Motor Brush (Large & Small) / Spring	09-75514-01	2	2			
39	Drive Belt, (3 Pk.)	0300604	1	3			
39a	Drive Belt, Single	75024-01	1	1			
40	Door Belt, White	75057-01-0431	1	1			
42	Brush Roll, Plastic Pulley	75202-01	1	1			
43	Seal, Baseplate	75008-01	1	1			
44	Spring Detent	75036-01	1	1			
45	Complete Baseplate Assembly, <b>order #44 also</b>	09-75715-01	1	1			
46	MICRO SWEEP Blade	75009-01	1	1			
47	Channel	75007-02	1	1			
50	Edge Brush w/Wheel, Left	09-75249-02	1	1			
	Edge Brush w/Wheel, Right	09-75250-02	1	1			
51	Wheel Axle	03-00630-01M	2	100			
52	Soft Rear Wheel, Black	75187-02-0327	2	1			

# Part Numbers Listing: XL9000D cont.

Regular Bag, No Lights, D Handle, Foot Switch

#	Item	Order #	Qty.	Pk.			
56	Cord Wrap Assembly including: Post Grip and Cord Wrap	09-75185-01	1	1			
57	Handle Tube	75029-01	1	1			
60	Motor Spring	75283-01	2	1			
61	Tube Label	75087-06	1	1			
64	Grip, Black Set	09-75301-03	1	1			
65	"Oreck" Name Plate Label	75599-03	1	1			
66	Bushing	75275-01	1	1			
	User's Manual	75416-05	1	1			
	Vacuum Cleaner Cover	VACCOVER	1	1	NLA	NLA	NLA
	Magnet Clean Vacuum Protector	MC4BK	1	1			

# Part Numbers Listing: XL9100C

Regular Bag, Lights, and Foot Switch

#	Item	Order #	Qty.	Pk.				
1a	Handle Assembly	75030-03	1	1				
4	Bag Retainer Spring	75035-02	1	1				
6	Outer Bag, Dark Gray, Black, Dark Gray	75246-11	1	1				
7	Bag Clip, Blue, Gray	09-75078-02	1	1				
8	Connector Assembly w/Deflector & Collar	0152657	1	1				
8a	Deflector, Black	75220-01-0327	1	1				
9	Collar	0132513	2	1				
10	Tube Assembly w/Seal & Clips	75017-01	1	1				
11	Grip, Handle, White	75272-01	1	1				
12	Fan Housing Assembly <i>includes: Rivet &amp; Spring</i>	09-75233-01	1	1				
13	Switch Cover	09-75266-01	1	1				
14	Switch Assembly	75084-06	1	1				
16	End Cap, Left	0134623	1	1				
18	METAXALLOY™ Fan Kit w/Washers	09-75300-01	1	1				
19	Fan Seal Cup	75012-01	1	1				
20	Cord Set	75079-02	1	1				
21	Lamp Housing w/Reflectors, Blue Gray	09-75073-03	1	1				
22	Lens	75058-01-0329	1	1				
23	Bulb	00965-0019	2	1				
24	Bulb Reflector	75034-01	4	1				
25	Lamp Holder	75539-01	1	1				
26	Housing, Blue Gray <b>when replacing on unit w/o belt door order #40 &amp; #48 also</b>	09-75429-04	1	1				
27	Bumper, White	75181-03	1	1				
28	Intake Pivot Assembly <i>with Felt Seal</i>	09-75066-02	1	1				
29	Felt Seal	75065-01	1	1				
32	Felt Seal, Motor	75117-01M	1	100				
33	Cord Retainer, Round	03-00455-01	1	1				
	Cord Retainer, Square	03-00494-01	1	1				
34	Motor Assembly Kit	09-75535-01	1	1				
35	Motor Seal	75095-01	2	1				
36	Kit, Motor Brush (Large & Small) / Spring	09-75514-01	2	2				
39	Drive Belt, (3 Pk.)	0300604	1	3				
39a	Drive Belt, Single	75024-01	1	1				
40	Door (Belt), Blue Gray	75057-01-0434	1	1				
42	Brush Roll, Plastic Pulley	75202-01	1	1				
43	Seal, Baseplate	75008-01	1	1				
44	Spring Detent	75036-01	1	1				

# Part Numbers Listing: XL9100C cont.

Regular Bag, Lights, and Foot Switch

#	Item	Order #	Qty.	Pk.			
45	Complete Baseplate Assembly, <b>order #44 also</b>	09-75715-01	1	1			
46	MICRO SWEEP Blade	75009-01	1	1			
47	Channel	75007-02	1	1			
50	Edge Brush w/Wheel, Left	09-75249-02	1	1			
	Edge Brush w/Wheel, Right	09-75250-02	1	1			
51	Wheel Axle	03-00630-01M	2	100			
52	Soft Rear Wheel, Black	75187-02-0327	2	1			
60	Motor Spring	75283-01	2	1			
61	Tube Label	75087-06	1	1			
62	Cord Bracket	75245-01	1	1			
66	Bushing	75275-01	1	1			
	User's Manual	75416-05	1	1			
	Magnet Clean Vacuum Protector	MC4BK	1	1			

# Part Numbers Listing: XL9100HG

## Hypo Bag, Lights, and Helping Hand Handle

#	Item	Order #	Qty.	Pk.			
1b	Handle Assembly, <i>includes items #38, #53, #54, #55, #56, #57, #59</i>	09-75296-02	1	1			
1d	Grip & Cord Assembly includes: #54, #55, #59	09-75342-01	1	1	NLA	NLA	NLA
1e	Kit, Retro, Handle Assembly, Residential, White	09-75612-01	1	1			
4	Bag Retainer Spring	75035-02	1	1			
6	Outer Bag, Dark Gray, Black, Dark Gray	75246-11	1	1			
7	Bag Clip, Blue Gray	09-75078-02	1	1			
8	Connector Assembly w/Deflector & Collar	0152657	1	1			
8a	Deflector, Black	75220-01-0327	1	1			
9	Collar	0132513	2	1			
10	Tube Assembly w/Seal & Clips	75017-01	1	1			
12	Fan Housing Assembly <i>includes: Rivet &amp; Spring</i>	09-75233-01	1	1			
16	End Cap, Left	0134623	1	1			
18	METAXALLOY™ Fan Kit w/Washers	09-75300-01	1	1			
19	Fan Seal Cup	75012-01	1	1			
20	Cord Set	<b>see #59</b>					
21	Lamp Housing w/Reflectors, Blue Gray	09-75073-03	1	1			
22	Lens	75058-01-0329	1	1			
23	Bulb	00965-0019	2	1			
24	Bulb Reflector	75034-01	4	1			
25	Lamp Holder	75539-01	1	1			
26	Housing w/Reflectors, Blue Gray <b>when replacing on unit w/o belt door order #40 &amp; #48 also</b>	09-75240-03	1	1			
27	Bumper, White	75181-03	1	1			
28	Intake Pivot Assembly <i>with Felt Seal</i>	09-75066-02	1	1			
29	Felt Seal	75065-01	1	1			
32	Felt Seal, Motor	75117-01M	1	100			
33	Cord Retainer, Round	03-00455-01	1	1			
34	Motor Assembly Kit	09-75535-01	1	1			
35	Motor Seal	75095-01	2	1			
36	Kit, Motor Brush (Large & Small) / Spring	09-75514-01	2	2			
39	Drive Belt, (3 Pk.)	0300604	1	3			
39a	Drive Belt, Single	75024-01	1	1			
40	Door (Belt), Blue Gray	75057-01-0434	1	1			
42	Brush Roll, Plastic Pulley	75202-01	1	1			
43	Seal, Baseplate	75008-01	1	1			
44	Spring Detent	75036-01	1	1			
45	Complete Baseplate Assembly, <b>order #44 also</b>	09-75715-01	1	1			



# Part Numbers Listing: XL9100HG cont.

Hypo Bag, Lights, and Helping Hand Handle

#	Item	Order #	Qty.	Pk.			
46	MICRO SWEEP Blade	75009-01	1	1			
47	Channel	75007-02	1	1			
50	Edge Brush w/Wheel, Left	09-75249-02	1	1			
	Edge Brush w/Wheel, Right	09-75250-02	1	1			
51	Wheel Axle	03-00630-01M	2	100			
52	Soft Rear Wheel, Black	75187-02-0327	2	1			
53	Static Wire	75037-01	1	1			
54	Switch	75110-02	1	1			
55	Grip Set, Blue Gray, <b>Order Assembly 1e</b>						
56	Cord Wrap Assembly <i>including:</i> Post Grip and Cord Wrap	09-75185-02	1	1			
57	Handle Tube	75029-01	1	1			
58	Cord, Harness Assembly	75081-01	1	1			
59	Cord Set, <b>Order Assembly 1e</b>						
60	Motor Spring	75283-01	2	1			
61	Tube Label	75087-06	1	1			
	User's Manual	75416-05	1	1			
	Magnet Clean Vacuum Protector	MC4BK	1	1			

# Part Numbers Listing: XL9300C/9300G/9300H/9300MM

Commercial, Hypo and Regular Bag, NoLights, and Helping Hand Handle

#	Item	Order #	Qty.	Pk.			
1b	Handle Assembly, <i>includes items #38, #53, #54, #55, #56, #57, #59</i>	09-75296-04 (C/H/MM) 09-75296-05 (G)	1	1			
1d	Grip & Cord Assembly includes: #54, #55, #59	09-75342-09 (C/H/MM) 09-75342-10 (G)	1	1	NLA NLA	NLA NLA	NLA NLA
1e	Kit, Retro, Handle Assembly, Commercial, Red	09-75611-01	1	1			
4	Bag Retainer Spring	75035-01	1	1			
6	Outer Bag, Lt. Gray, Black, Dark Gray (H, C)	75246-10	1	1			
	Outer Bag, Dark Gray, Black, Dark Gray (G)	75246-11	1	1			
	<b>9300MM:</b> Outer Bag, Blue Gray w/Green	75246-08	1	1			
7	Bag Clip, Green (C/H/MM)	09-75078-01	1	1			
	Bag Clip, Tangerine (G)	09-75078-04	1	1			
8	Connector Assembly w/Deflector & Collar	0152657	1	1			
8a	Deflector, Black	75220-01-0327	1	1			
9	Collar	0132513	2	1			
10	Tube Assembly w/Seal & Clips	75017-01	1	1			
12	Fan Housing Assembly <i>includes: Rivet &amp; Spring</i>	09-75233-01	1	1			
16	End Cap, Left	0134623	1	1			
18	METAXALLOY™ Fan Kit w/Washers	09-75300-01	1	1			
19	Fan Seal Cup	75012-01	1	1			
20	Cord Set	<b>see #59</b>					
26	Housing, Green (C/H/MM)	09-75430-17	1	1			
	Housing, Tangerine (G) <b>when replacing on unit w/o belt door order #40 &amp; #48 also</b>	09-75430-03	1	1			
27	Bumper, Clear	75181-04	1	1			
28	Intake Pivot Assembly <i>with Felt Seal</i>	09-75066-02	1	1			
29	Felt Seal	75065-01	1	1			
32	Felt Seal, Motor	75117-01M	1	100			
33	Cord Retainer, Round	03-00457-01	1	1			
	Cord Retainer, Square	03-00494-01	1	1			
34	Motor Assembly Kit	09-75505-01	1	1			
35	Motor Seal	75095-01	2	1			
36	Kit, Motor Brush (Large & Small) / Spring	09-75514-01	2	2			
39	Drive Belt, (3 Pk.)	0300604	1	3			
39a	Drive Belt, Single	75024-01	1	1			
40	Door (Belt), Green (C/H/MM)	75057-01-0433	1	1			
	Door (Belt), Tangerine (G)	75057-01-0435	1	1			
42	Brush Roll, Plastic Pulley	75202-01	1	1			
43	Seal, Baseplate	75008-01	1	1			

# Part Numbers Listing: XL9300C/9300G/9300H/9300MM

Commercial, Hypo and Regular Bag, No Lights, and Helping Hand Handle

#	Item	Order #	Qty.	Pk.			
44	Spring Detent	75036-01	1	1			
45	Complete Baseplate Assembly, <b>order #44 also</b>	09-75715-03	1	1			
46	MICRO SWEEP Blade	75009-01	1	1			
47	Channel	75007-02	1	1			
50	Edge Brush, w/o wheels	75766-02	2	1			
51	Wheel Axle	03-00630-01M	2	100			
52	Soft Rear Wheel, Black	75187-02-0327	2	1			
53	Static Wire	75037-01	1	1			
54	Switch	75110-02	1	1			
55	Grip Set, Green (C/H/MM), <b>Order Assembly 1e</b>						
	Grip Set, Tangerine (G), <b>Order Assembly 1e</b>						
56	Cord Wrap Assembly including: Post Grip and Cord Wrap (C/H/MM)	09-75185-03	1	1			
	Cord Wrap Assembly including: Post Grip and Cord Wrap (G)	09-75185-04	1	1			
57	Handle Tube	75029-01	1	1			
58	Cord, Harness Assembly, Black	75082-02	1	1			
59	Cord Set, <b>Order Assembly 1e</b>						
60	Motor Spring	75283-01	2	1			
61	Tube Label	75087-06	1	1			
65	"Oreck" Commercial N.P. Label	75599-02	1	1			
	User's Manual	75417-05	1	1			
	Vacuum Cleaner Cover	VACCOVER	1	1	NLA	NLA	NLA
	Magnet Clean Vacuum Protector	MC4BK	1	1			

# Part Numbers Listing: XL9300/9300S/9300MS

Commercial, Hypo and Regular Bag, No Lights, and Foot Switch

#	Item	Order #	Qty.	Pk.			
1a	Handle Assembly	75030-04	1	1			
4	Bag Retainer Spring	75035-01	1	1			
6	Outer Bag, Dark Gray, Black, Dark Gray	75246-11	1	1			
	Outer Bag, Lt.Gray, Black Dark Gray (S)	75246-10	1	1			
	Outer Bag, Blue, Gray w/Green (MS)	75246-08	1	1			
7	Bag Clip, Tangerine	09-75078-04	1	1			
	Bag Clip, Green, (S, MS)	09-75078-01	1	1			
8	Connector Assembly w/Deflector & Collar	0152657	1	1			
8a	Deflector	75220-01-0327	1	1			
9	Collar	0132513	2	1			
10	Tube Assembly w/Seal & Clips	75017-01	1	1			
11	Grip, Handle, Black	75272-02	1	1			
12	Fan Housing Assembly <i>includes: Rivet &amp; Spring</i>	09-75233-01	1	1			
13	Switch Cover	09-75266-01	1	1			
14	Switch Assembly, Grounded	75084-05	1	1			
16	End Cap, Left	0134623	1	1			
18	METAXALLOY™ Fan Kit w/Washers	09-75300-01	1	1			
19	Fan Seal Cup	75012-01	1	1			
20	Cord Set, White	75080-05-328	1	1			
	Cord Set, Tangerine	75080-03	1	1			
26	Housing, Tangerine	09-75430-04	1	1			
	Housing, Green, (S, MS) <b>when replacing on unit w/o belt door order #40 &amp; #48 also</b>	09-75430-16	1	1			
27	Bumper, Clear	75181-04	1	1			
28	Intake Pivot Assembly <i>with Felt Seal</i>	09-75066-02	1	1			
29	Felt Seal	75065-01	1	1			
32	Felt Seal, Motor	75117-01M	1	100			
33	Cord Retainer, Round	03-00457-01	1	1			
	Cord Retainer, Square	03-00494-01	1	1			
34	Motor Assembly Kit	09-75505-01	1	1			
35	Motor Seal	75095-01	2	1			
36	Kit, Motor Brush (Large & Small) / Spring	09-75514-01	2	2			
39	Drive Belt, (3 Pk.)	0300604	1	3			
39a	Drive Belt, Single	75024-01	1	1			
40	Door Belt, Tangerine	75057-01-0435	1	1			
	Door Belt, Green (S, MS)	75057-01-0433	1	1			
42	Brush Roll, Plastic Pulley	75202-01	1	1			
43	Seal, Baseplate	75008-01	1	1			
44	Spring Detent	75036-01	1	1			

# Part Numbers Listing: XL9300/9300S/9300MS cont.

Commercial, Hypo and Regular Bag, No Lights, and Foot Switch

#	Item	Order #	Qty.	Pk.			
45	Complete Baseplate Assembly, <b>order #44 also</b>	09-75715-03	1	1			
46	MICRO SWEEP Blade	75009-01	1	1			
47	Channel	75007-02	1	1			
50	Edge Brush, w/o wheels	75766-02	2	1			
51	Wheel Axle	03-00630-01M	2	100			
52	Soft Rear Wheel, Black	75187-02-0327	2	1			
60	Motor Spring	75283-01	2	1			
61	Tube Label	75087-06	1	1			
62	Cord Bracket	75245-01	1	1			
65	"Oreck" Commercial N.P. Label	75599-02	1	1			
66	Bushing	75275-01	1	1			
	User's Manual	75417-05	1	1			
	Vacuum Cleaner Cover	VACCOVER	1	1	NLA	NLA	NLA
	Magnet Clean Vacuum Protector	MC4BK	1	1			

# WIRING DIAGRAM

FOR ALL 120V UPRIGHTS

## IMPORTANT SAFETY NOTES:

- UNPLUG UNIT BEFORE SERVICING.
- REPLACEMENT OF MOTORS SHOULD ONLY BE DONE BY AN EXPERIENCED ELECTRICIAN OR AN AUTHORIZED ORECK SERVICE CENTER.

75516-04 REV D 05/04 ECN# R-7618

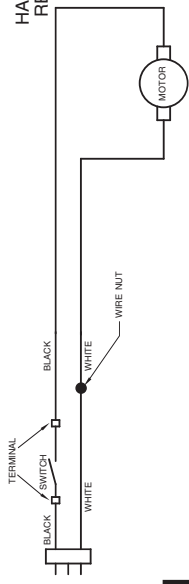

HARDWIRE IN HANDLE  
RESIDENTIAL SWITCH  
IN HANDLE  
W/O LIGHTS  
SEE MOTOR  
DETAIL A & B

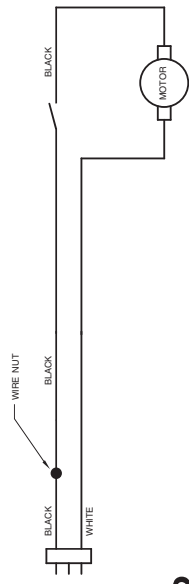

RESIDENTIAL  
SWITCH IN BASE  
W/O LIGHTS  
SEE MOTOR  
DETAIL A & B

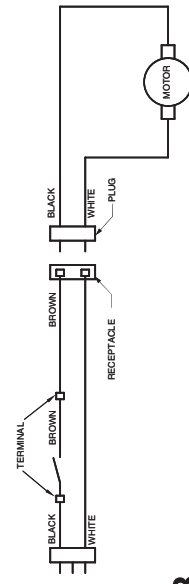

D-PLUG IN HANDLE  
RESIDENTIAL  
SWITCH IN HANDLE  
W/O LIGHTS  
SEE MOTOR  
DETAIL A & B

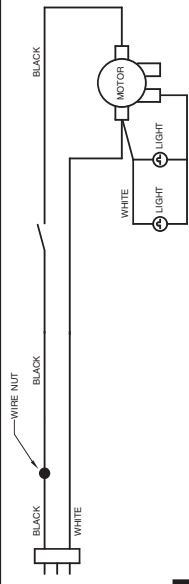

RESIDENTIAL  
SWITCH IN BASE  
W/LIGHTS  
1 PARALLEL  
LIGHT HARNESS  
SEE MOTOR  
DETAIL C & D

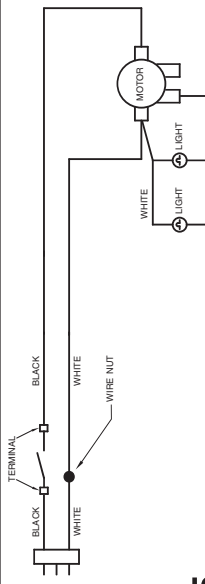

HARDWIRE  
IN HANDLE  
RESIDENTIAL  
SWITCH IN HANDLE  
W/LIGHTS  
1 PARALLEL  
LIGHT HARNESS  
SEE MOTOR  
DETAIL C & D

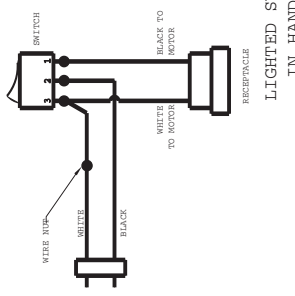

JOHNSON MOTOR  
RESIDENTIAL  
W/O LIGHTS

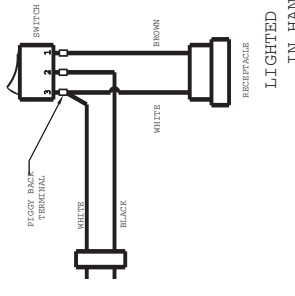

AMETEK MOTOR  
RESIDENTIAL  
W/O LIGHTS

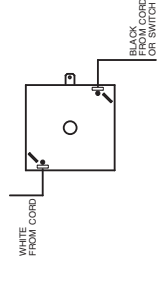

JOHNSON MOTOR  
RESIDENTIAL  
W/LIGHTS  
1 PARALLEL HARNESS

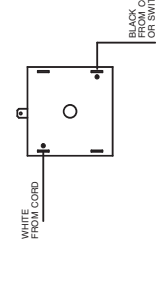

AMETEK MOTOR  
RESIDENTIAL  
W/LIGHTS  
1 PARALLEL HARNESS

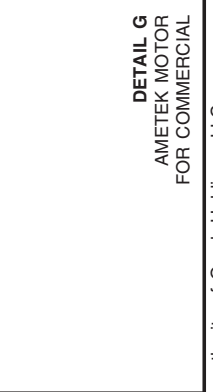
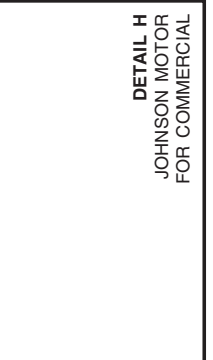
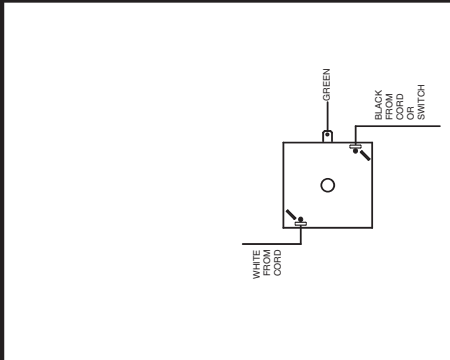
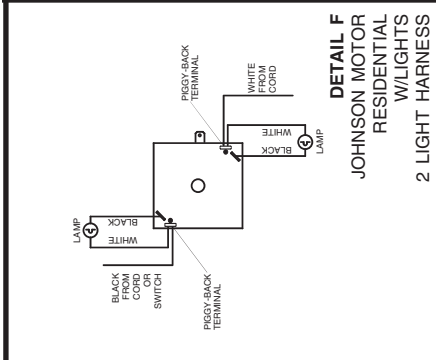
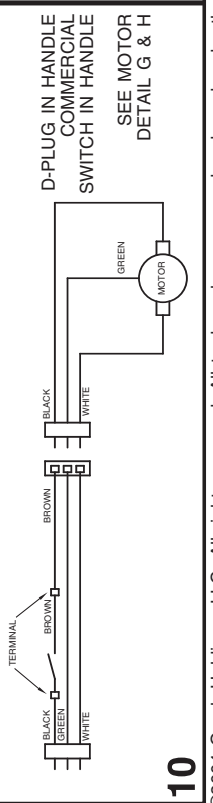
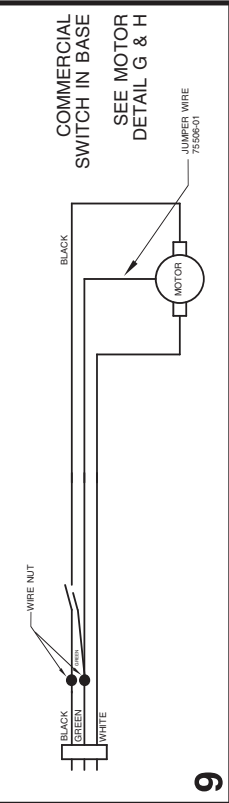
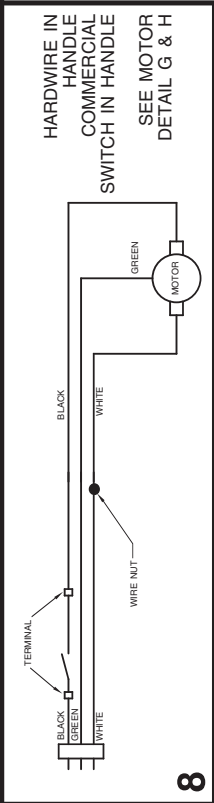
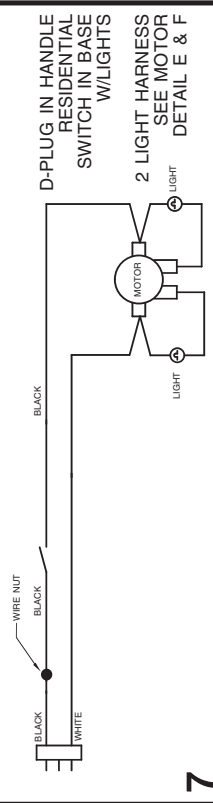
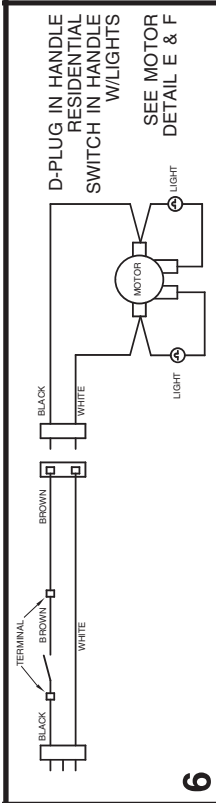

©2004 Oreck Holdings, LLC. All rights reserved. All trademarks are owned and used under the authority of Oreck Holdings, LLC.

# Troubleshooting

**Notice:** Make sure the unit is unplugged before removing any part off the unit.

<b>1. Problem Being Checked:</b>
----------------------------------

- |             |
|-------------|
| a. Solution |
|-------------|

**1. Dust Blowing from Bottom of Unit:**

- a. Change bag ensuring it's properly installed on connector deflector.
- b. Remove lower tube and check for clog. Remove any debris.
- c. Remove baseplate and check inlet for clog. Remove any debris.

**2. Unit not picking up:**

- a. Remove lower tube and check for clog.
- b. Remove baseplate and check inlet for clog.
- c. Change bag ensuring it's properly installed on connector deflector.
- d. Make sure belt is installed properly.

**3. Brush Roll Not Spinning / Belt Breaks:**

- a. Belt is older than six months and slipping or may not be installed properly. Install new belt.
- b. Bearings in brush roll worn, change brush roll.

**4. Sparking from Plug to Handle:**

- a. Make sure plug fits firmly into handle.

**5. Unit Dead:**

- a. Make sure unit is plugged into working outlet.
- b. Check switch for failure. If bad, replace switch.
- c. Check to see if motor wires are plugged and not loose.
- d. Check motor brushes and motor brush springs to make sure they have good contact.
- e. Check motor for failure. If bad, replace motor.
- f. Check cord for failure. If bad, replace cord.

**6. Parts Falling off Baseplate:**

- a. If wheels come off, replace wheels.
- b. If channel, micro sweep blade, or wireform come off, replace baseplate.

**7. Noisy Unit:**

- a. Check to see if brush roll has bad bearings. If so replace brush roll.
- b. Check to see if an object is stuck in the fan housing.
- c. Check fan in fan housing. Make sure there are no broken blades. Replace if broken.

**8. Unit Will Not Stand Up:**

- a. Make sure unit has plastic detent on housing.

**An Oreck Authorized Service Center should do all technical servicing.**